



LX1200
QUICK REFERENCE GUIDE

1

Installation

ATTENTION: Install touchscreen driver prior to making cable connections to your PC.

1. Touchscreen Setup -

- Refer to the User's Guide for touch set-up
- Latest touchscreen drivers are available at <http://apps.planar.com/downloads/touchscreen/>

2. SoftKey Set-up -

- Refer to the User's Guide for SoftKey set-up instructions.

3. Recommended Mounting -

- Planar recommends an approved mount for in-vehicle use.

4. Cable Connections -

(Sold Separately. Refer to the diagram below). To ensure reliability strain relief as needed.

1. USB Type B Upstream
2. VGA Video Cable
3. 12V Power Input
4. 3.5mm Audio Input Cable
5. Remote PC Shutdown/Start Control Cable (See User's Guide)

5. Power Up -

- Connect the video and power cables. The unit will display a test screen as soon as power is applied.
- Use 5A fuse and a timer switch to avoid draining the battery.
- Power up the computer. See the User's Guide for the LX1200 at www.planar.com/support for advanced set-up instructions.

6. Cleaning -

- Use a clean cloth to clean the display. If cleaning fluid is required, mild detergent or IPA can be used, if applied to the cloth first.

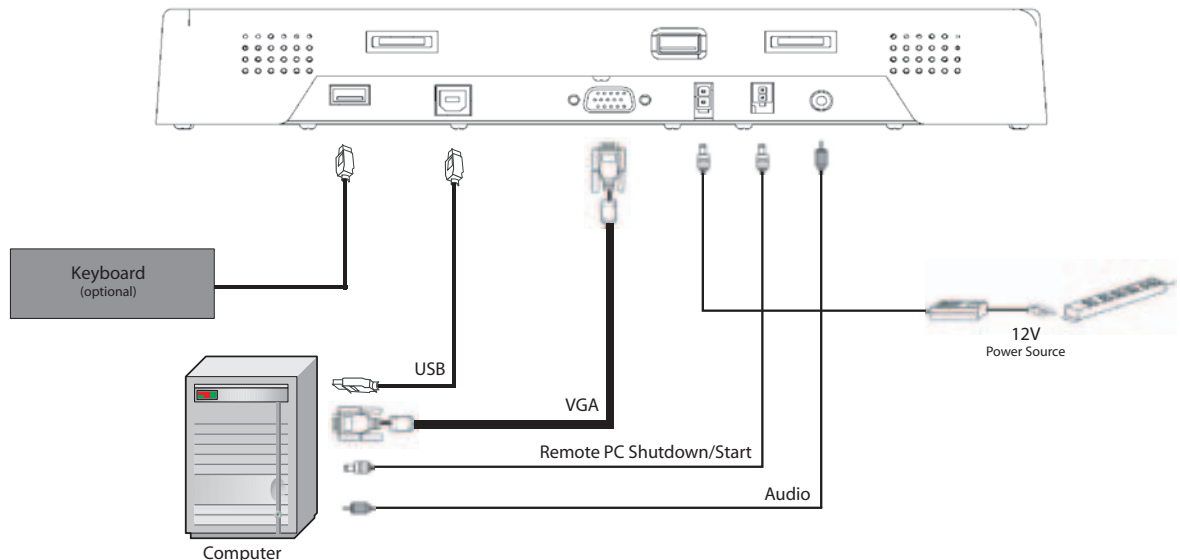

2

Features and User Controls

1. **USB Type A**
2. **Dimming Dial -**
 - Adjust brightness by turning the dial. Turn off the backlight for video blanking by turning the dial clockwise.
3. **Remote PC Shutdown/Start Button -**
(Sold Separately. Refer to the diagram below). To ensure reliability strain relief as needed.
 - This button doesn't turn off the monitor directly. When connected to a docking station it will act as the power button for the computer. When the computer is turned off, the LED will turn red and the monitor will go into standby. See User's Guide for more detail.
4. **Autosync -** Press button if video is not centered on screen
5. **Instant Off Backlight Button**
 - Backlight button will also restart the touchscreen if needed.
6. **Programmable SoftKey Macro Buttons -** Refer to the User's Guide
7. **Speaker Volume**
 - Adjust speaker volume by turning the dial.
8. **Remote PC LED Status Light**
 - Green - The display is receiving a video signal from the computer.
 - Red - Standby mode. No video signal.
 - Off - DC Power Off or Backlight Off.
9. **Backlight Status Light**
 - Green - Backlight On.
 - Red - Backlight Off.
 - Off - DC Power Off or No Video Signal.

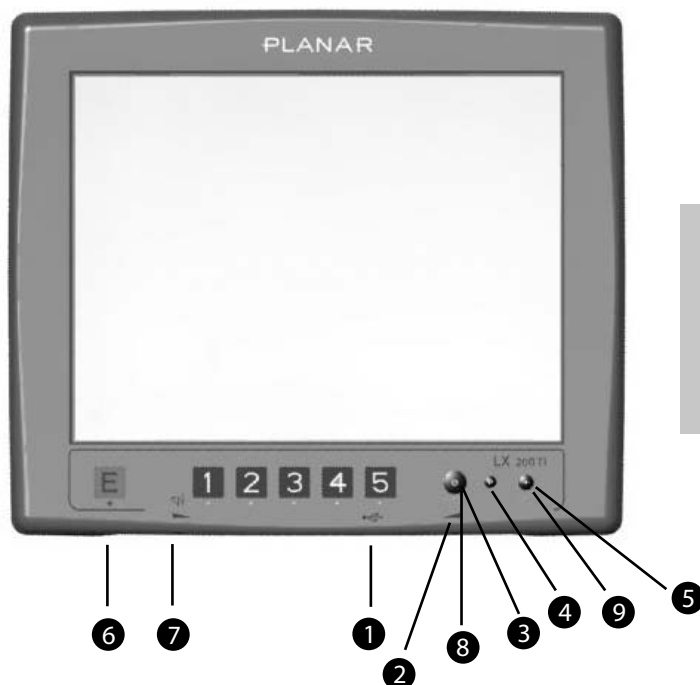

Features: 2-Port USB Hub, Video Blanking for Privacy and Bezel mounted button controls the Remote PC.

3

Troubleshooting Guide

- **Power On/Off Issues**
 - Remote PC power button (third from right) should be pressed and released to turn on or off laptop. Similar to the actual laptop power button a press and hold or repetitive presses will not work.
 - Ensure cabling is correctly installed and strain relieved.
- **Touchscreen Issues**
 - Backlight button (far right) can be pressed twice to reset touchscreen.
 - Ensure latest touchscreen driver is used from -
<http://apps.planar.com/downloads/touchscreen/>
 - Ensure cabling is correctly installed and strain relieved.
- **Video Noise or Issues**
 - Ensure ground strap is used and properly attached from monitor to computer.
 - Ensure cabling is correctly installed and strain relieved.

Thank you for choosing Planar's LX1200 LCD touchscreen monitor.

Customer Service:

To view online documentation and frequently asked questions, or to send an email to our technical support staff, please visit:

<http://www.planar.com/support>

1.866.PLANAR1 (1.866.752.6271)

To receive advanced notification of product updates, please register your monitor at **www.planar.com/support**.

11/2008

020-0967-00 Rev A