



## Full Resolution, Robust, High Performance Network-Oriented Imaging

The Planar Imager (PLI) Full Resolution Video Wall Workstation is designed for large-scale video walls comprised of up to 48 Full HD Planar displays. The PLI has the capacity to run applications and draw the application's output at the full native resolution of all the displays within the video wall. With its network orientation, PLI is designed to receive data feeds to maintain live, high-quality visual data on the video wall. It acts as a seamless desktop spread across the entire video wall. Optionally, screen captures can be brought on to the video wall via Planar's Indisys Software. Using only industrial strength components, the PLI designed for 24x7 operation.

# Efficient, full resolution

Fewer connections to the video wall mean simpler cabling, more reliability

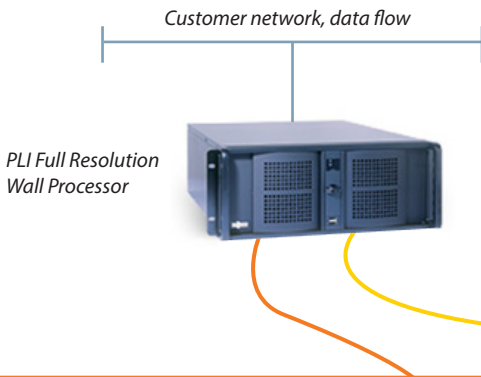

PLI Full Resolution Wall Processor

When paired with Planar Rear Projection Video Wall Cubes or Clarity™ Matrix LCD Video Wall System, PLI intelligently utilizes the advanced graphics built into every Planar display. For example, just two video outputs from PLI, each at ultra HD (4K), can drive a video wall comprised of eight full HD Planar displays.

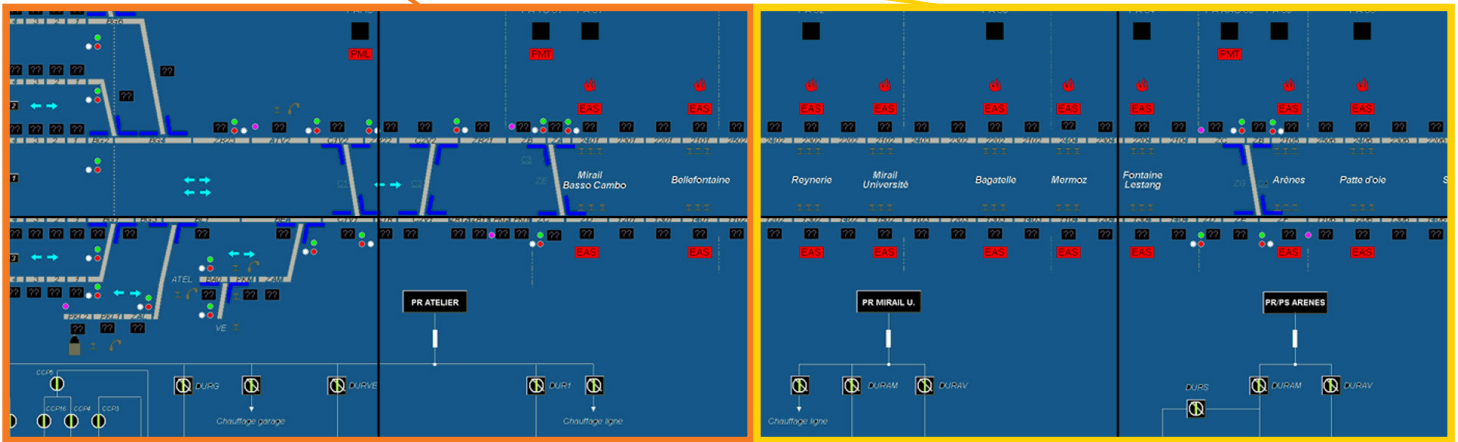

Video wall is comprised of eight Full HD Planar displays and is fed a full 8 x Full HD, or 7680 x 2160 pixels.

## Superior hardware, superior image

Each PLI is configured with graphic output capacity to match the needs of the video wall. The workstation's 4U rack chassis has capability for the largest, most demanding jobs. Redundant power supplies can be added. Multiple Ethernet inputs can be configured for use on separate networks or in redundant failover mode. RAID 0/1 options are available for the hard drives. Applications are loaded and run on the PLI, or may be hosted remotely and connected to the PLI over the network.

The PLI can also be fitted with multiple motherboard processors to be able to handle the toughest application requirements. Each output graphics card employed has the industry's leading performance for video computation. The PLI workstation otherwise operates as any Windows computer, just with an ultra-high pixel density desktop.

### Big, full resolution visualization

- SCADA Diagrams
- Giant desktops for multiple applications
- Geospatial maps
- Large simulation images
- Presentations

# Redundancy when Integrated with Indisys Source Processing

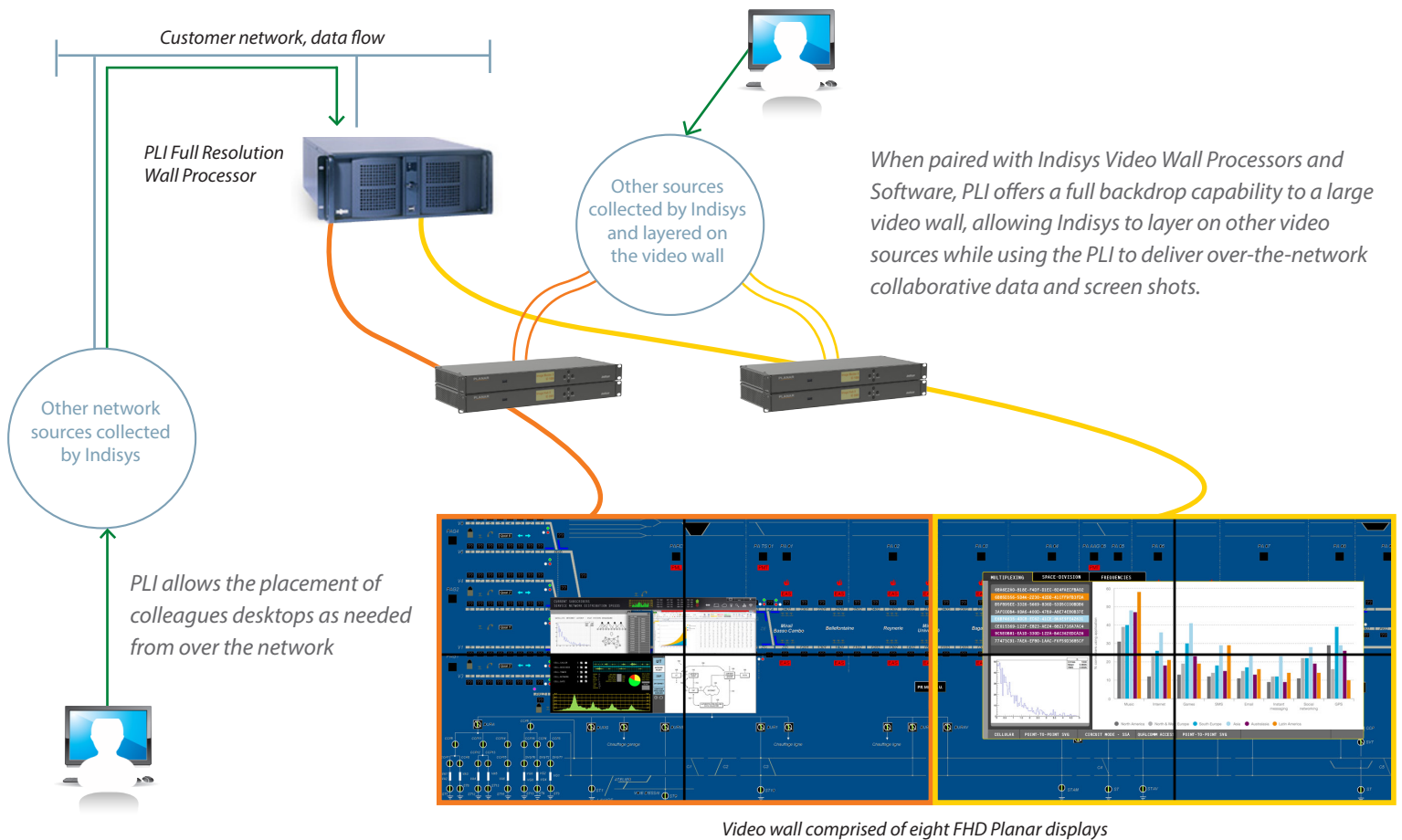

## Integrate with Planar Indisys Video Processing

Planar's Indisys™ Video Wall Processor is a set of high-performance source-collecting video processors implemented in modular at-the-wall components. PLI can be paired with Indisys to offer additional advantages and features to the wall. When combined with Indisys, PLI delivers a large full resolution desktop backdrop to the video wall allowing other source video images to be overlaid in front of the PLI Windows desktop. Although video sources are processed separately from the application data, video images and application windows are integrated seamlessly on the displays. This architecture separating video sources from network data adds a fundamental redundancy to the solution that other all-in-one processors lack.

What's more, the PLI desktop can be used by the Indisys Desktop Service software to receive collaborative desktops from a variety of computer hosts throughout the control room and to post those screen grabs on the wall. When combined with Indisys, the PLI makes for a complete and high-end video wall processing set up.

### Industrial Performance for all your needs

- High MTBF components
- Advanced cooling chassis for 24 hours operation
- Powerful GPU for better utilization
- Latest professional processors and memory modules

The PLI is offered into two ranges: The Ultra featuring Intel i7 processor and the eXtreme featuring Intel Xeon E5 processor.

	ULTRA: PLI-U2/4/8			EXTREME: PLI-X4/8/12		
	-U2	-U4	-U8	-X4	-X8	-X12
<b>Output</b>	2 Digital outputs	4 Digital outputs	8 Digital outputs	4 Digital outputs	8 Digital outputs	12 Digital outputs
<b>Typical Uses</b>	Provides an extended Windows desktop across Planar Rear Projection Video Wall or Clarity Matrix LCD Video Wall System. Can be paired with Indisys Video Processing solution.					
<b>Planar Displays Supported</b>	Up to 8 FHD*	Up to 16 FHD*	Up to 32 FHD*	Up to 16 FHD*	Up to 32 FHD*	Up to 48 FHD*
	*Number of displays supported depends on display type and video wall layout.					
<b>Processor</b>	1x Intel® iCore i7 Processor			1x Intel® Xeon® Processor E5 family PLI-X12 comes with Dual processors standard		
<b>Optional Processor</b>	n/a			Dual Xeon Processor for -X4 & -X8		
<b>Hard disk drive</b>	RAID 0/1 or RAID 5, or RAID 10			RAID 0/1 or RAID 5, or RAID 10		
<b>Power Supply</b>	Single Power Supply			Redundant 1+1 Power Supply, Hot swap Module		
<b>Optional Power</b>	Redundant 1+1 Power Supply, Hot swap Module					
<b>Ethernet</b>	2 Ethernet ports.*			4 Ethernet ports.*		
	*If the PLI is used with Planar Indisys Video Wall Processing, one network port is dedicated to the private Indisys network. Additional cards required if failover redundancy is needed.					
<b>Optional Ethernet</b>	Additional Ethernet Cards with 1, 2 or 4 ports.			Additional Ethernet Cards with 1, 2 or 4 ports.		
<b>Operating System</b>	Windows 7 64 bit (Inquire about other Operating Systems)			Windows 7 64 bit (Inquire about other Operating Systems)		
<b>Languages Supported</b>	English, French, Spanish, Portugese, Italian, German			English, French, Spanish, Portugese, Italian, German		
<b>Dimension</b>	4U Rack high 427 x 177 x 480mm			4U Rack high 437 x 178 x 648mm (W x D x H)		
<b>Misc</b>	USB keyboard and mouse DVD +/- RW DVD +/- RW			USB keyboard and mouse		

